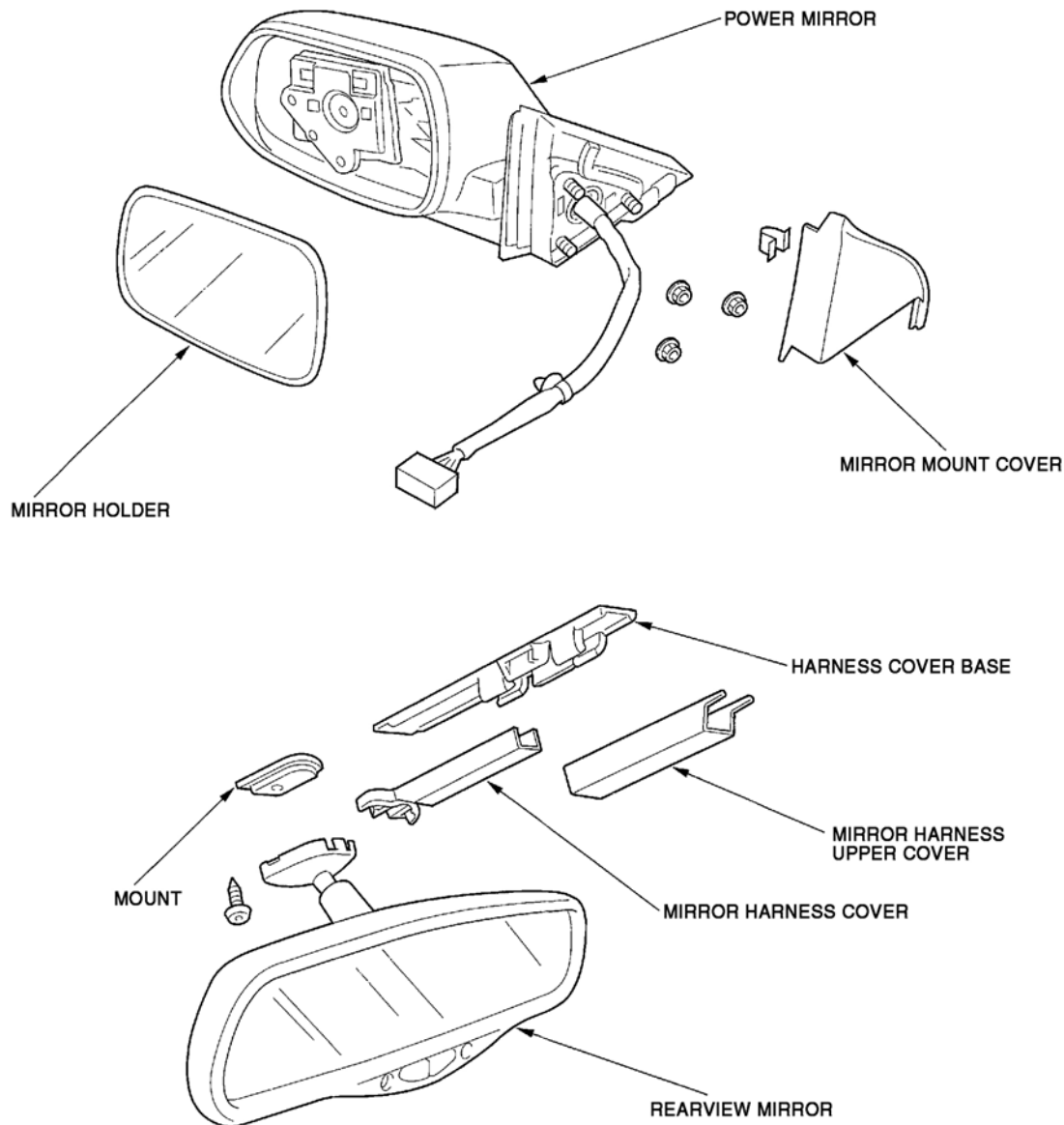


## 2004 ACCESSORIES & EQUIPMENT

### Power Mirrors & Automatic Dimming Inside Mirror - TSX

## MIRRORS

### COMPONENT LOCATION INDEX



G01818909

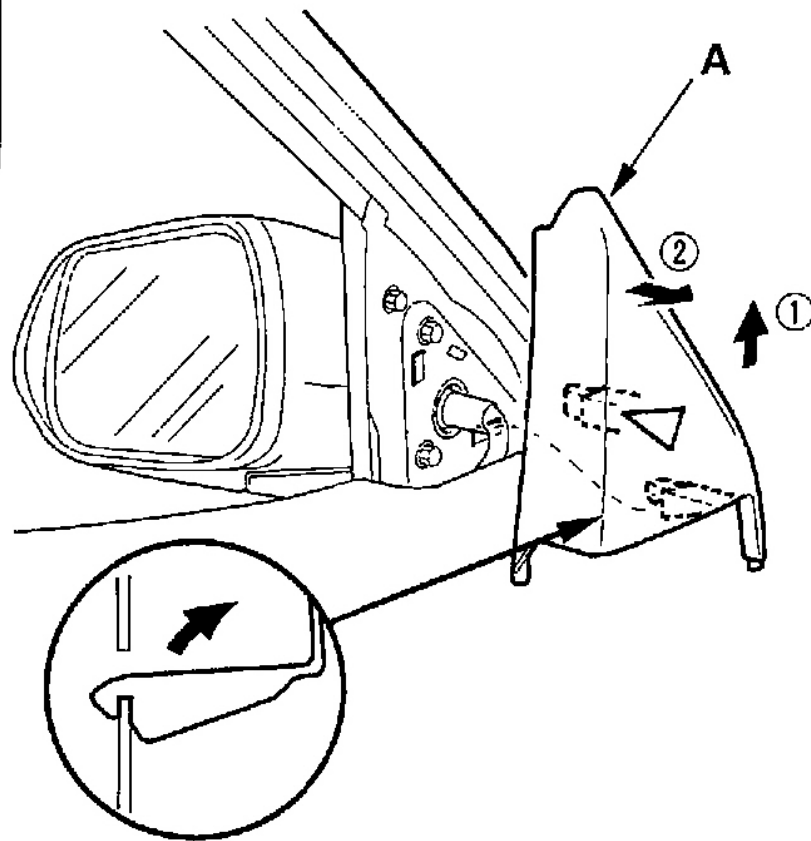
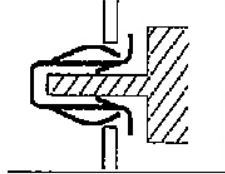
**Fig. 1: Locating Mirror Components**

### POWER MIRROR REPLACEMENT

1. Lower the door glass fully.
2. Carefully pry out the mirror mount cover (A) by hand in the sequence shown.

### Fastener Location

▷ : Clip, 1



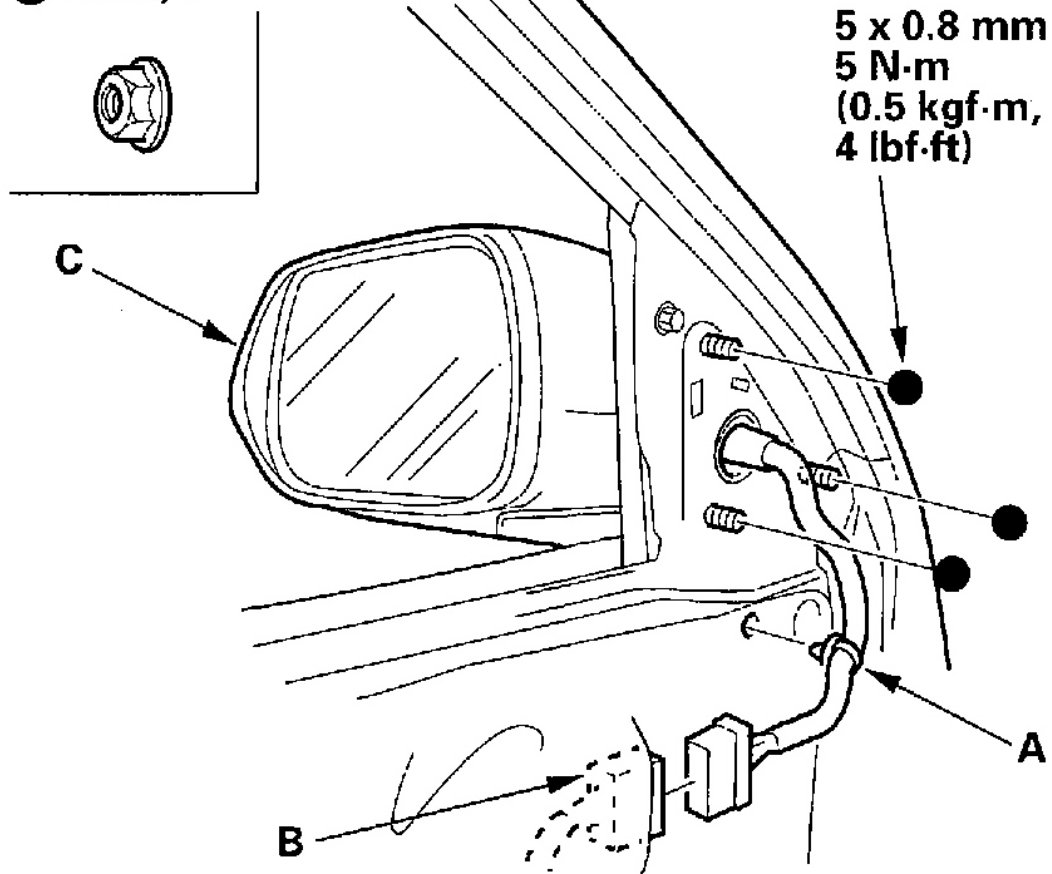
G01818910

**Fig. 2: Prying Out The Mirror Mount Cover**

3. Remove the door panel (see **FRONT DOOR PANEL REMOVAL/INSTALLATION** ).
4. Remove the plastic cover as necessary, then detach the harness clip (A), and disconnect the connector (B). While holding the mirror (C), remove the nuts.

**Fastener Locations**

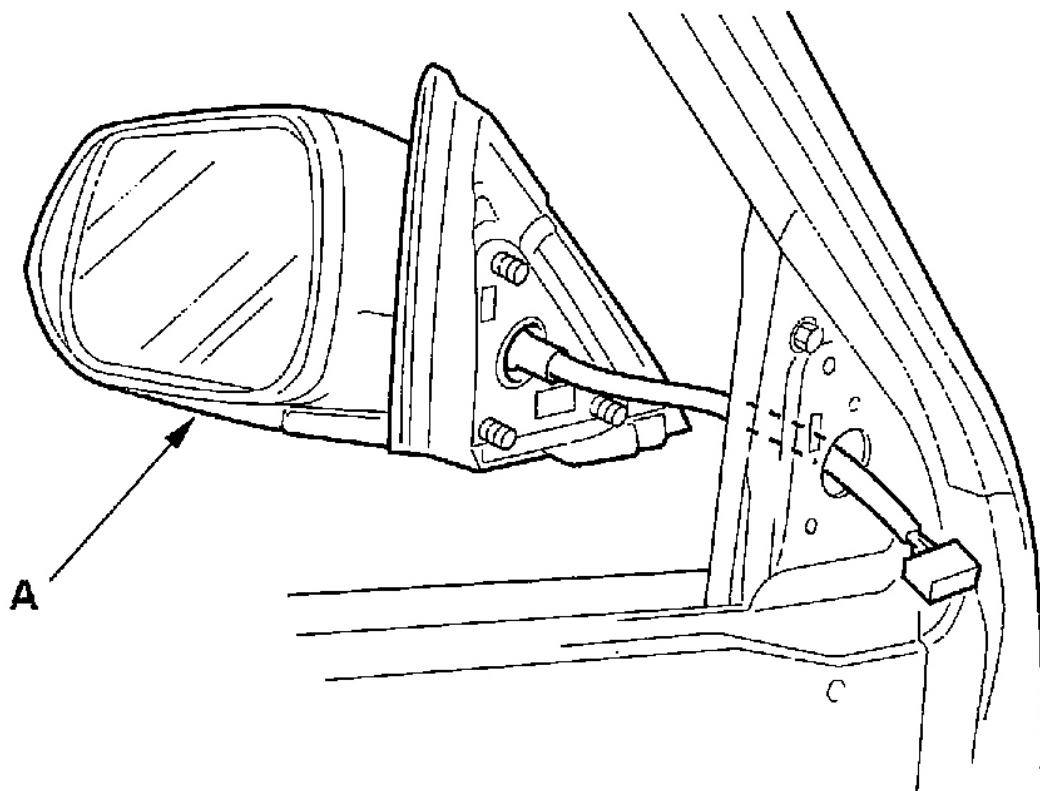
● : Nut, 3



G01818911

**Fig. 3: Disconnecting The Connector**

5. Remove the mirror (A). Take care not to scratch the door.



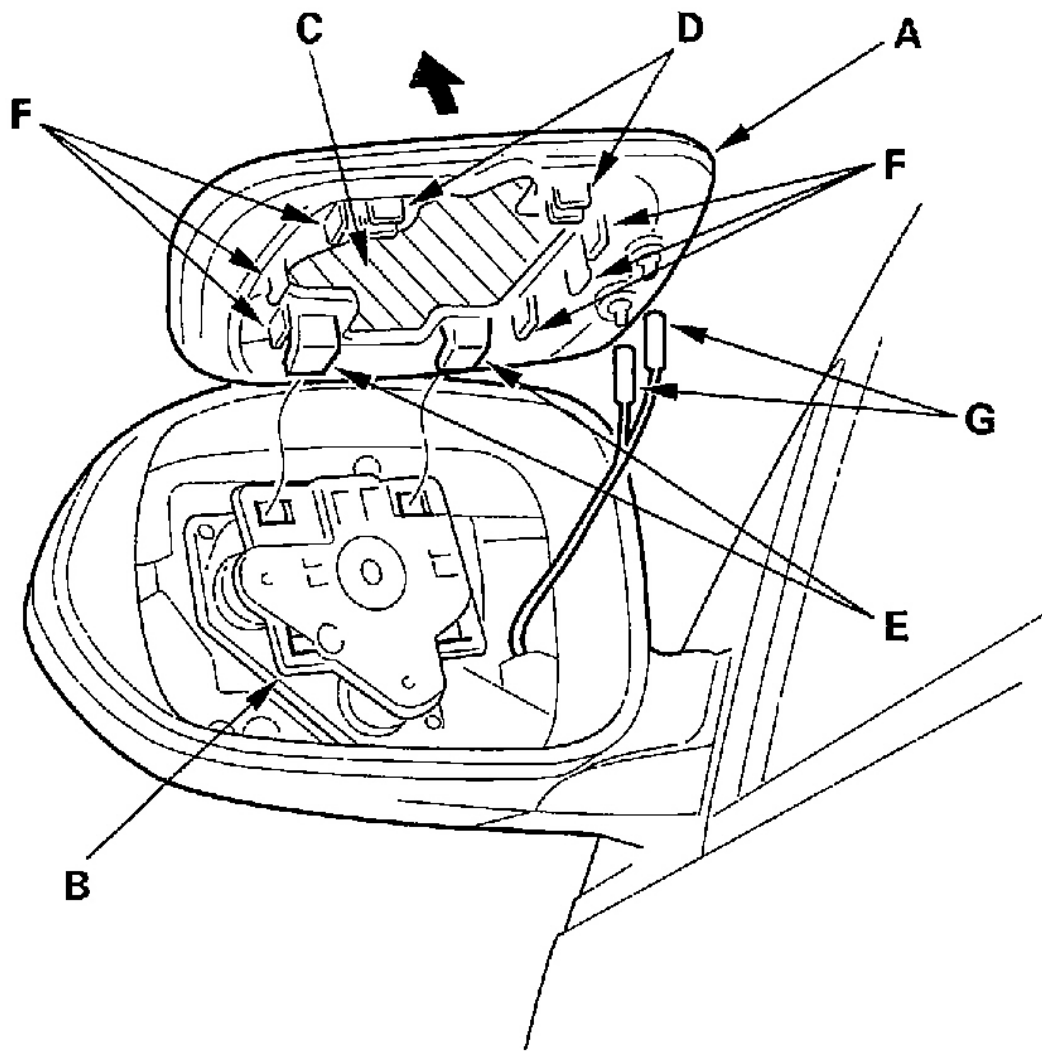
G01818912

**Fig. 4: Removing The Mirror**

6. Install the mirror in the reverse order of removal, and make sure the connector is plugged in properly.

**MIRROR HOLDER REPLACEMENT**

1. Carefully pull out the bottom edge of the mirror holder (A) by hand. Take care not to scratch the mirror.



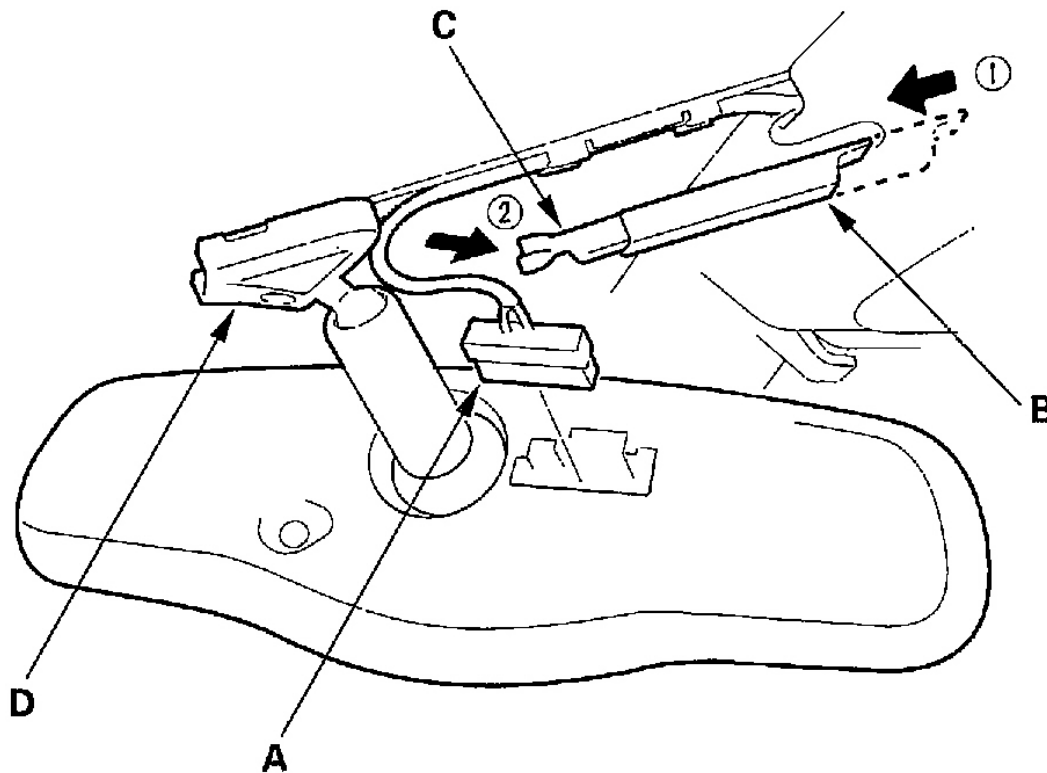
G01818913

**Fig. 5: Pulling Out The Mirror Holder**

2. Separate the mirror holder from the actuator (B) by slowly pulling them apart while removing the adhesive (C), detaching the clips (D), and releasing the hooks (E, F). If equipped, disconnect the mirror defogger connectors (G).
3. If equipped, reconnect the mirror defogger connectors.
4. Reattach the hooks of the mirror holder to the actuator, then position the mirror holder on the actuator. Carefully push on the clip portions of the mirror holder until the mirror holder locks into place.
5. Check the operation of the actuator.

**REARVIEW MIRROR REPLACEMENT**

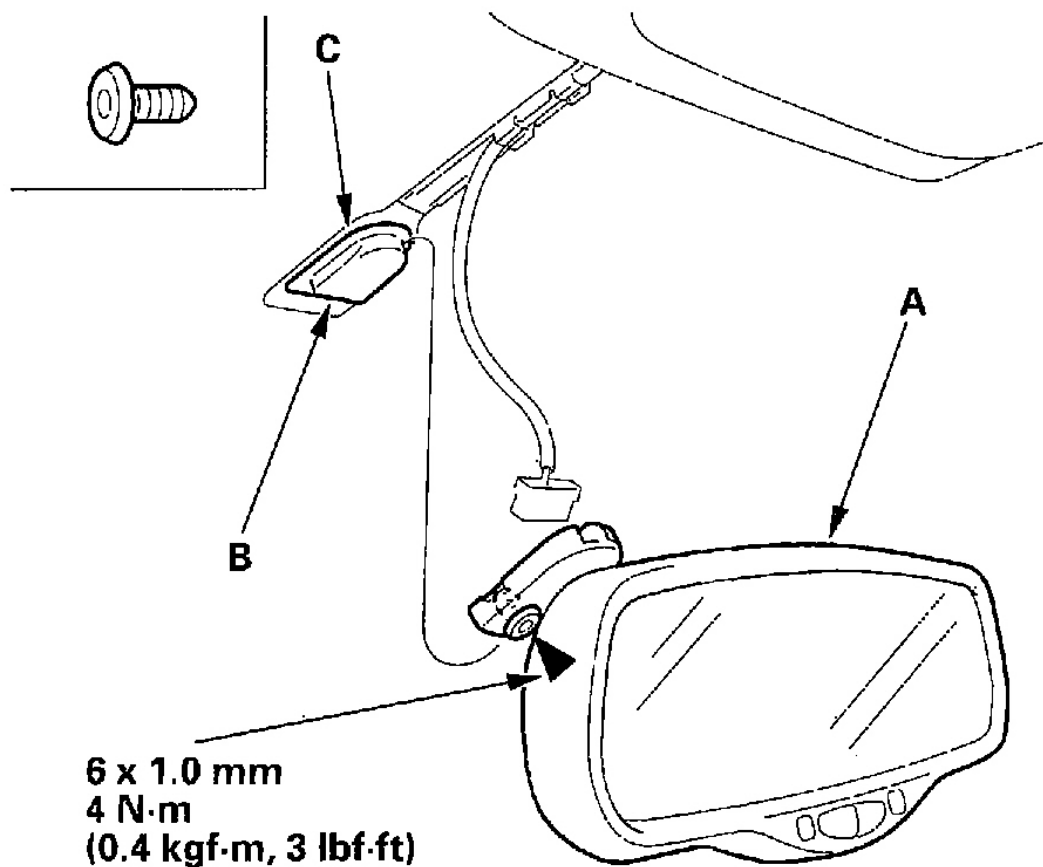
1. Disconnect the connector (A).



G01818914

**Fig. 6: Disconnecting The Connector**

2. Slide the mirror harness upper cover (B) forward, then remove the mirror harness cover (C) from the mirror base (D).
3. Using a Torx T20 bit, loosen the bolt, then slide the rearview mirror (A) rearward and off the mount (B).

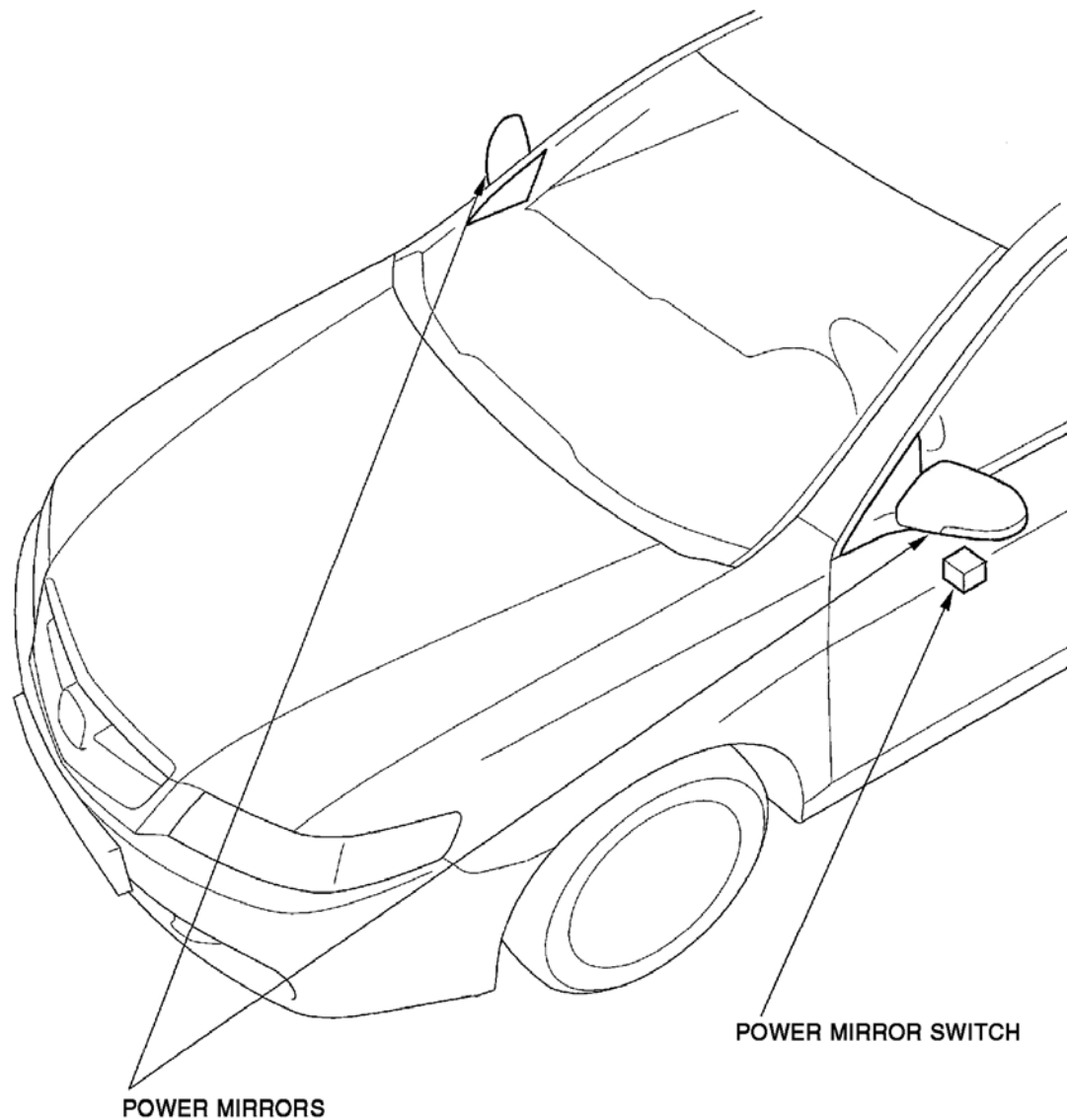
**Fastener Location****► : Bolt, 1**

G01818915

**Fig. 7: Removing Rearview Mirror**

4. Install the mirror in the reverse order of removal, and note these items:
  - Before installing the mirror, remove the Torx screw, and apply liquid thread lock to it.
  - Make sure the connector is plugged in properly.

**POWER MIRRORS****COMPONENT LOCATION INDEX**

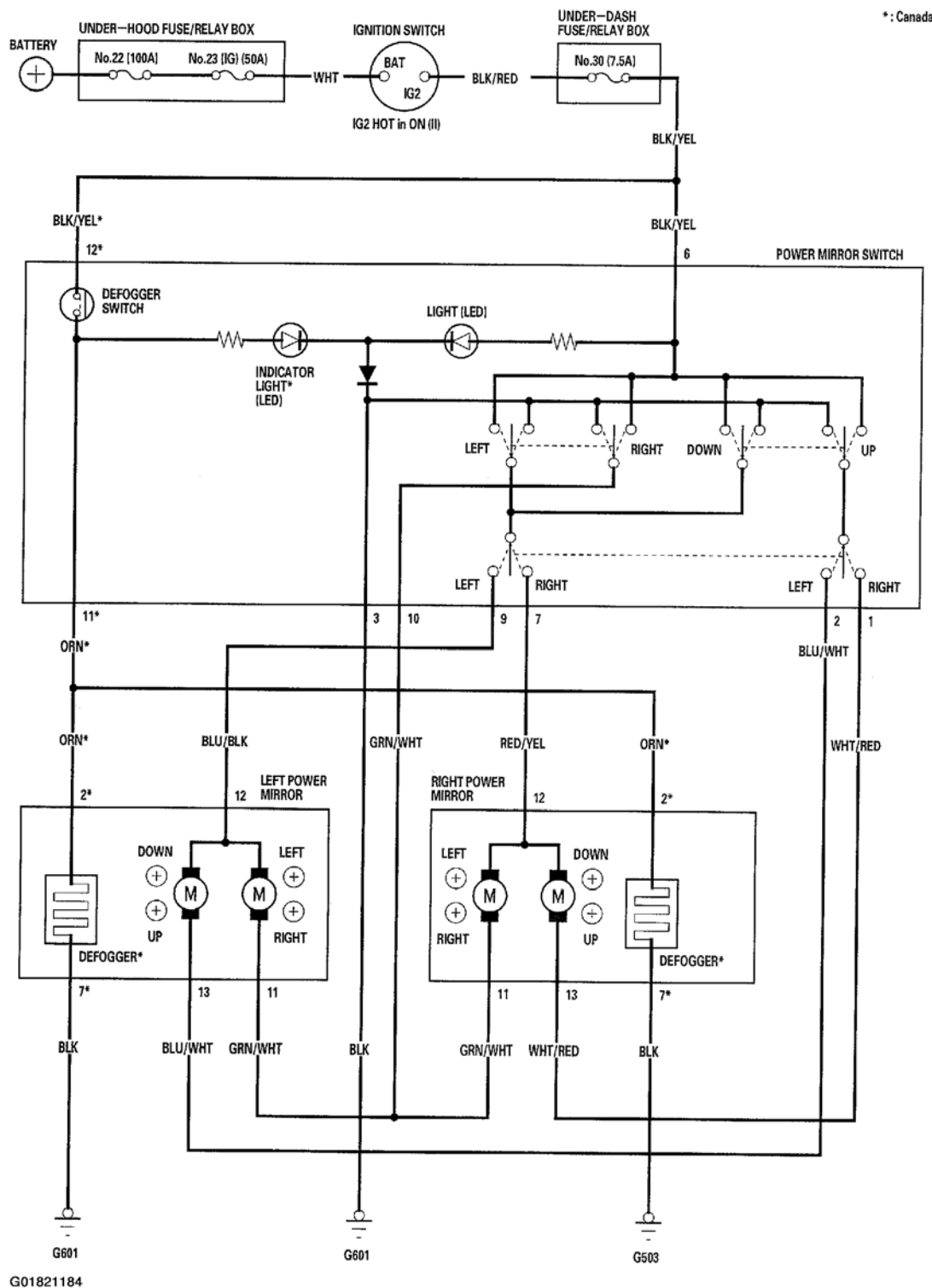


G01821183

**Fig. 8: Locating Power Mirror Components**

**CIRCUIT DIAGRAM**

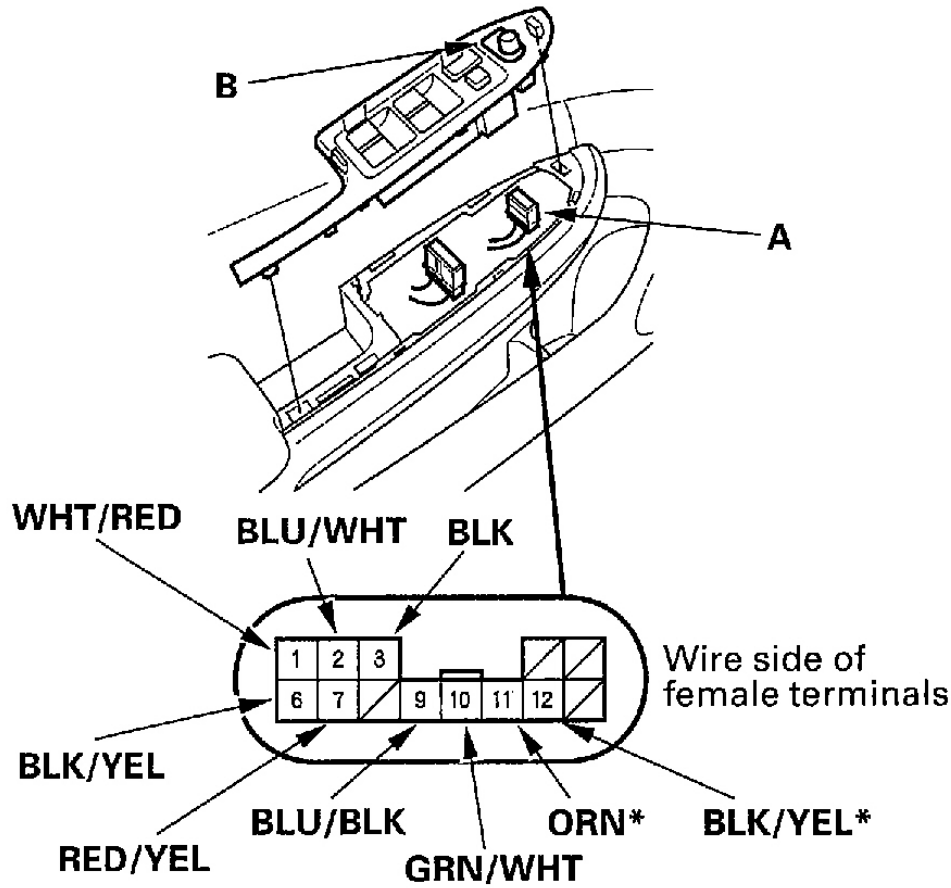




**Fig. 9: Power Mirror Wiring Diagram**

## FUNCTION TEST

1. Remove the driver's door switch trim (see **FRONT DOOR PANEL REMOVAL/INSTALLATION** ).



\*: Canada

G01821185

**Fig. 10: Removing The Driver's Door Switch Trim**

2. Disconnect the 13P connector (A) from the power mirror switch (B), and inspect the terminals. If OK, go to step 3.
3. Choose the appropriate test based on the symptom:
  - Both mirrors don't work, go to step 4.
  - Left mirror doesn't work, go to step 6 .
  - Right mirror doesn't work, go to step 7 .
  - Defogger doesn't work (Canada), go to step 8 .

**Both Mirrors:**

4. Check for voltage between the No. 6 terminal and body ground with the ignition switch ON (II). There should be battery voltage.
  - If there is no battery voltage, check for:
    - blown No. 30 (7.5A) fuse in the under-dash fuse/relay box.
    - an open in the BLK/YEL wire.
  - If there is battery voltage, go to step 5.
5. Check for continuity between the No. 3 terminal and body ground. There should be continuity.
  - If there is no continuity, check for:
    - an open in the BLK wire.
    - poor ground (G 601).
  - If there is continuity, check both mirrors individually.

**Left Mirror:**

6. Connect the No. 6 terminal to the No. 9 terminal, and the No. 2 (or No. 10) terminal to the No. 3 terminal with jumper wires. The left mirror should tilt down (or swing left) with the ignition switch ON (II).
  - If the mirror does not tilt down (or does not swing left), check for an open in the BLU/WHT (or GRN/WHT) wire between the left mirror and the 13P connector. If the wire is OK, check the left mirror actuator.
  - If the mirror neither tilts down nor swings left, repair the BLU/BLK wire.
  - If the mirror works properly, check the mirror switch.

**Right Mirror:**

7. Connect the No. 6 terminal to the No. 7 terminal, and the No. 1 (or No. 10) terminal to the No. 3 terminal with jumper wires. The right mirror should tilt down (or swing left) with the ignition switch ON (II).
  - If the mirror does not tilt down (or does not swing left), check for an open in the WHT/RED (or GRN/WHT) wire between the right mirror and the 13P connector. If the wire is OK, check the right mirror actuator.
  - If the mirror neither tilts down nor swings left, repair the RED/YEL wire.
  - If the mirror works properly, check the mirror switch.

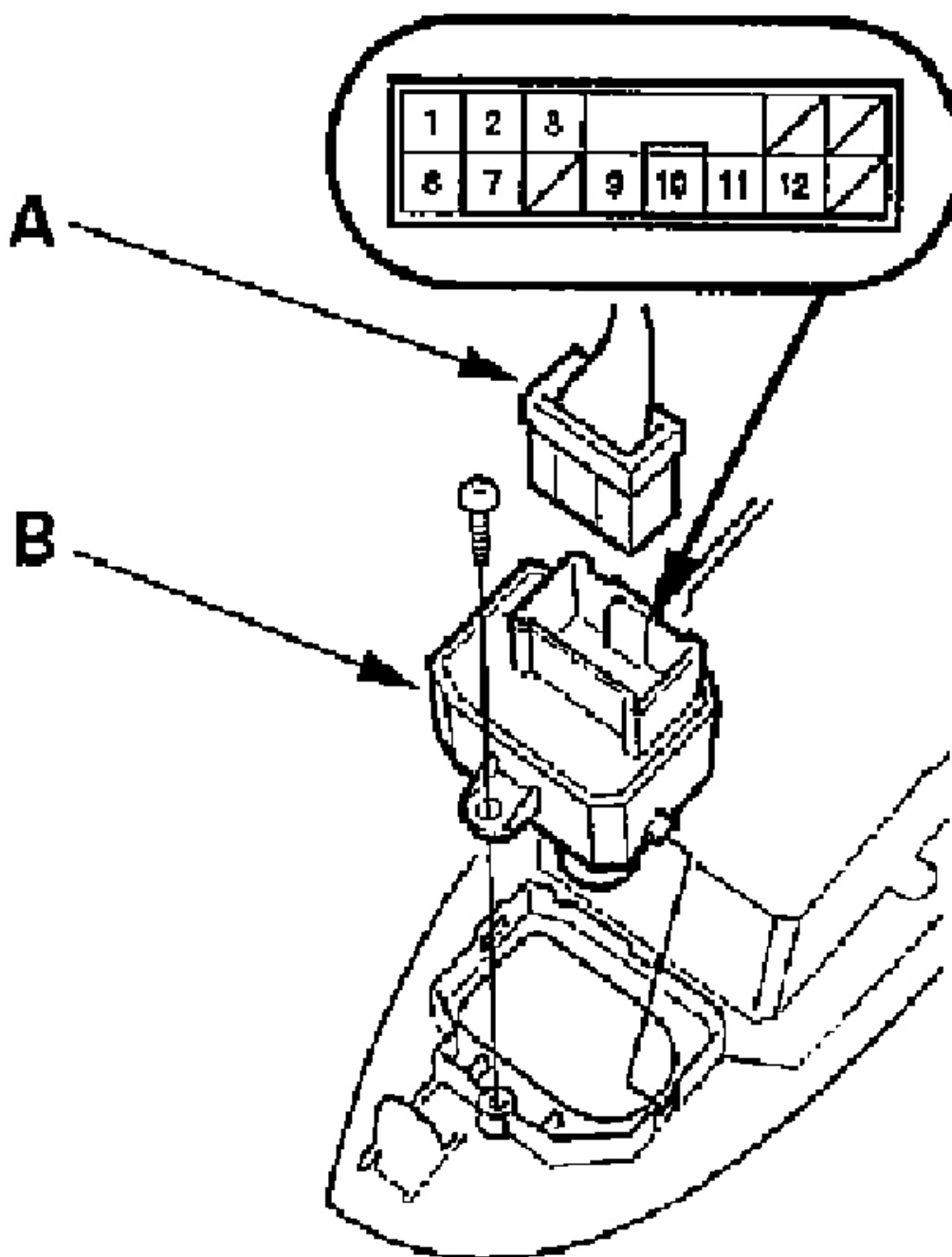
**Defogger (Canada):**

8. Connect the No. 12 and No. 11 terminals with a jumper wire, and check for voltage between the No. 2 terminal of the mirror connectors and body ground. There should be battery voltage and both mirrors should warm up with the ignition switch ON (II).
  - If there is no voltage or neither warms up, check for:
    - an open in the BLK/YEL or ORN wire.
    - blown No. 30 (7.5A) fuse in the under-dash fuse/relay box.
  - If only one fails to warm up, check:
    - its defogger.

- poor ground at G601 (left mirror) or G503 (right mirror).
- If both warm up, check the defogger switch.

#### **POWER MIRROR SWITCH TEST/REPLACEMENT**

1. Remove the driver's door switch trim (see **FRONT DOOR PANEL REMOVAL/INSTALLATION** ).
2. Disconnect the 13P connector (A) from the power mirror switch (B).



G01821186


**Fig. 11: Removing The Driver's Door Switch Trim**

3. Check for continuity between the terminals in each switch position according to the table.

Terminal Position		1	2	3	6	7	9	10
L	UP		○	○	○		○	
	DOWN		○	○	○		○	
	LEFT			○	○		○	○
	RIGHT			○	○		○	○
R	UP	○		○	○	○		
	DOWN	○		○	○	○		
	LEFT			○	○	○		○
	RIGHT			○	○	○		○

G01821187

**Fig. 12: Power Mirror Switch Test Table**

Terminal Position	11	12
ON		
OFF		

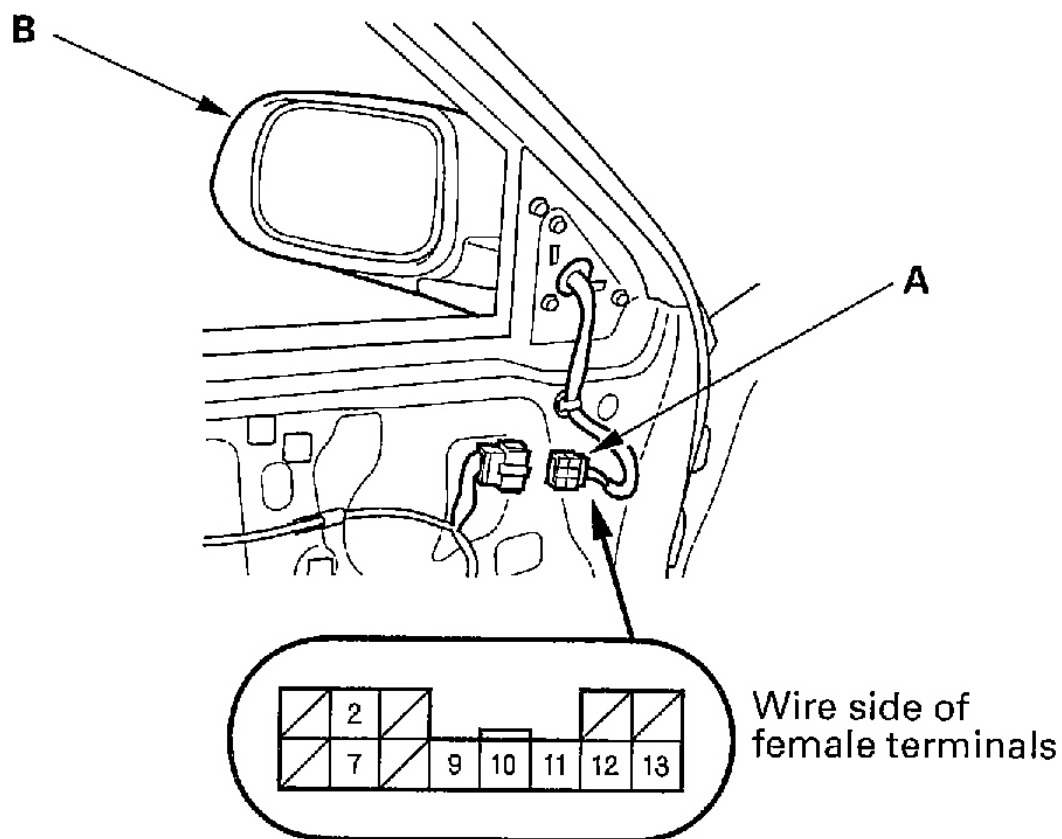
G01821188

**Fig. 13: Defogger Switch Test Table (Canada)**

4. If the continuity is not as specified, replace the power mirror switch.

**POWER MIRROR ACTUATOR TEST**

1. Remove the door panel (see **FRONT DOOR PANEL REMOVAL/INSTALLATION** ).
2. Disconnect the 13P connector (A) from the power mirror actuator (B).



G01821189

**Fig. 14: Disconnecting The 13P Connector From The Power Mirror Actuator**

3. Check actuator operation by connecting power and ground according to the table.



Terminal Position	11	12	13
TILT UP		⊖	⊕
TILT DOWN		⊕	⊖
SWING LEFT	⊖	⊕	
SWING RIGHT	⊕	⊖	

G01821190

**Fig. 15: Power Mirror Actuator Test Table**

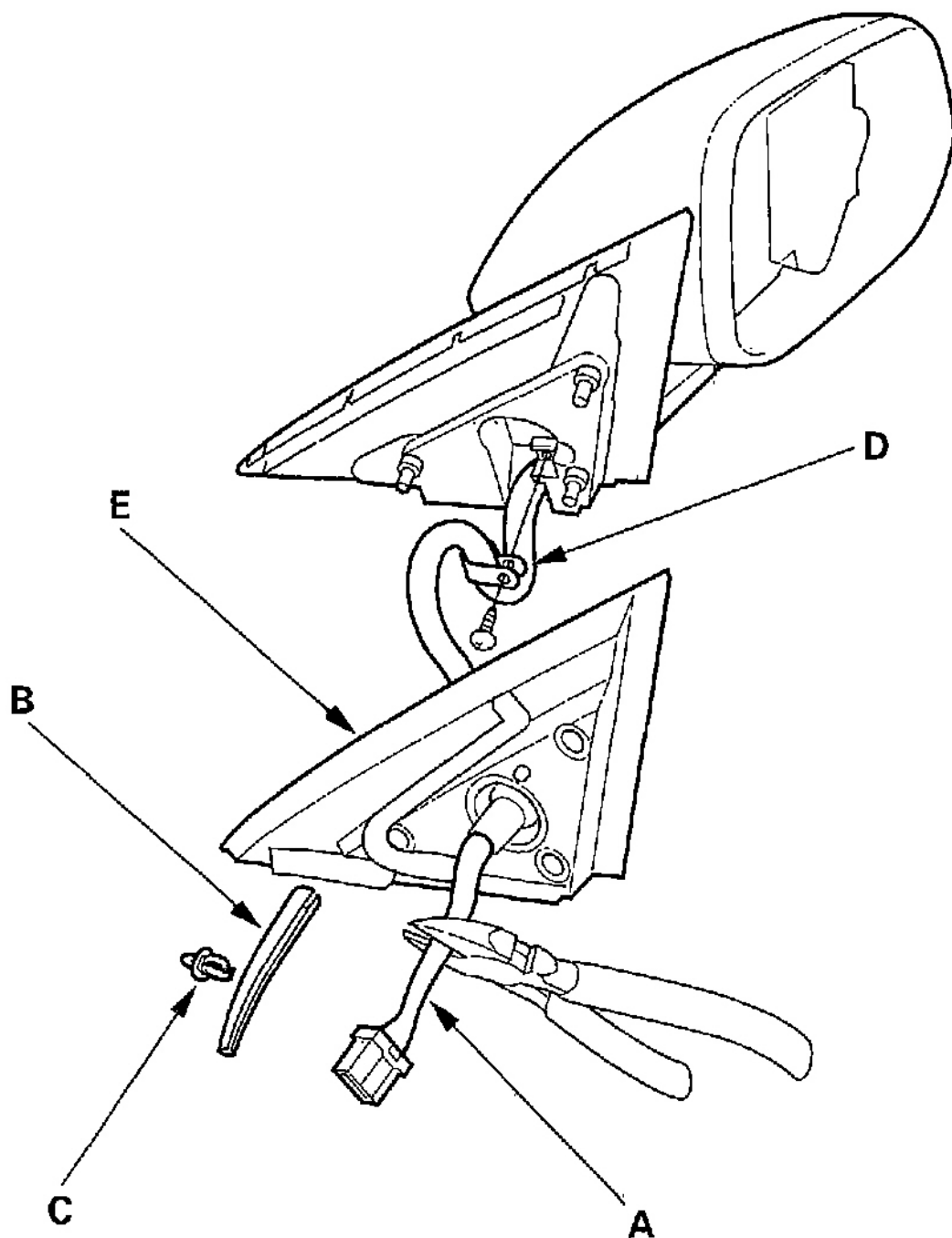
- If the mirror fails to work properly, replace the mirror actuator.

**Defogger Test (Canada):**

- Check for continuity between the No. 2 and No. 7 terminals of the 13P connector. There should be continuity with the defogger switch ON. If there is no continuity, check for an open circuit.

**POWER MIRROR ACTUATOR REPLACEMENT**

- Remove the mirror holder (see **MIRROR HOLDER REPLACEMENT** ), power mirror (see **POWER MIRROR REPLACEMENT** ), and disconnect the connector.
- Cut the wire harness (A), tube (B) with cutter, and remove the clip (C).

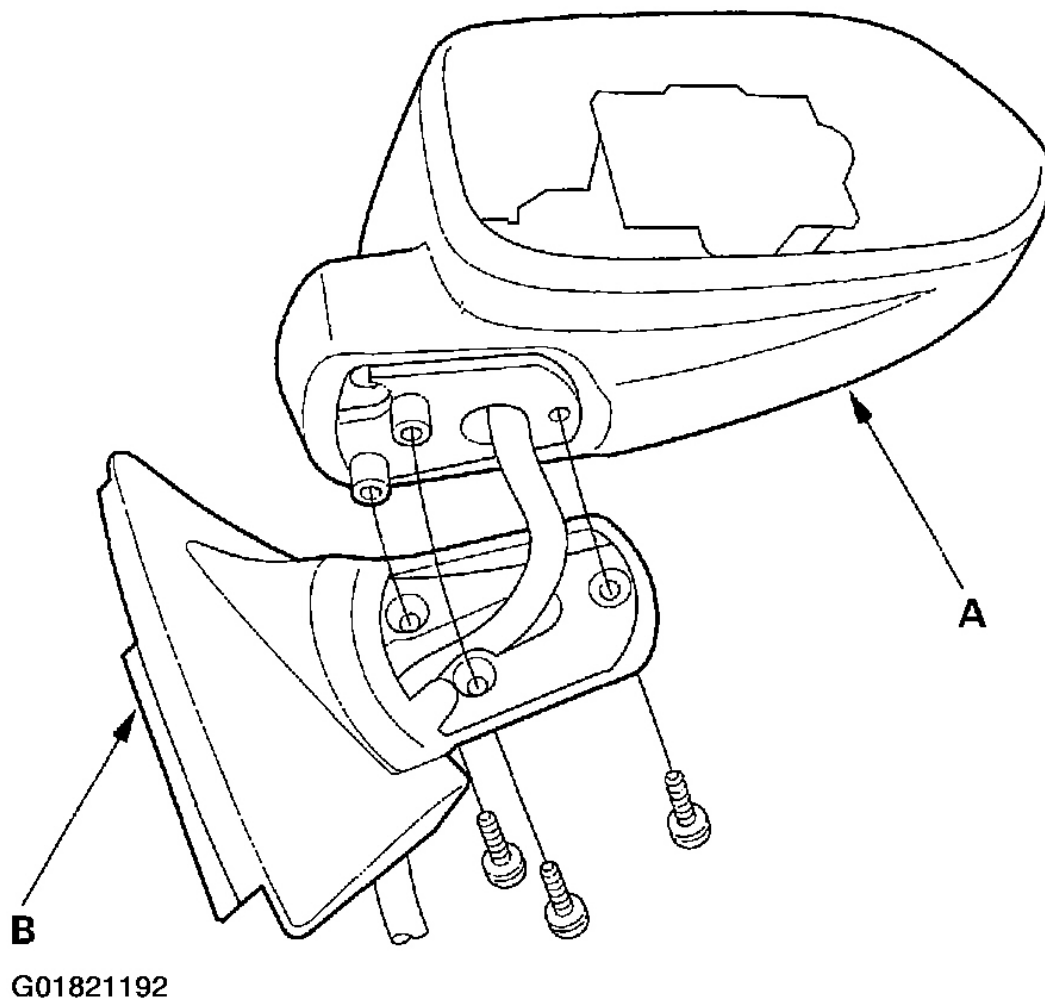


G01821191

**Fig. 16: Cutting The Wire Harness Tube & Removing The Clip**

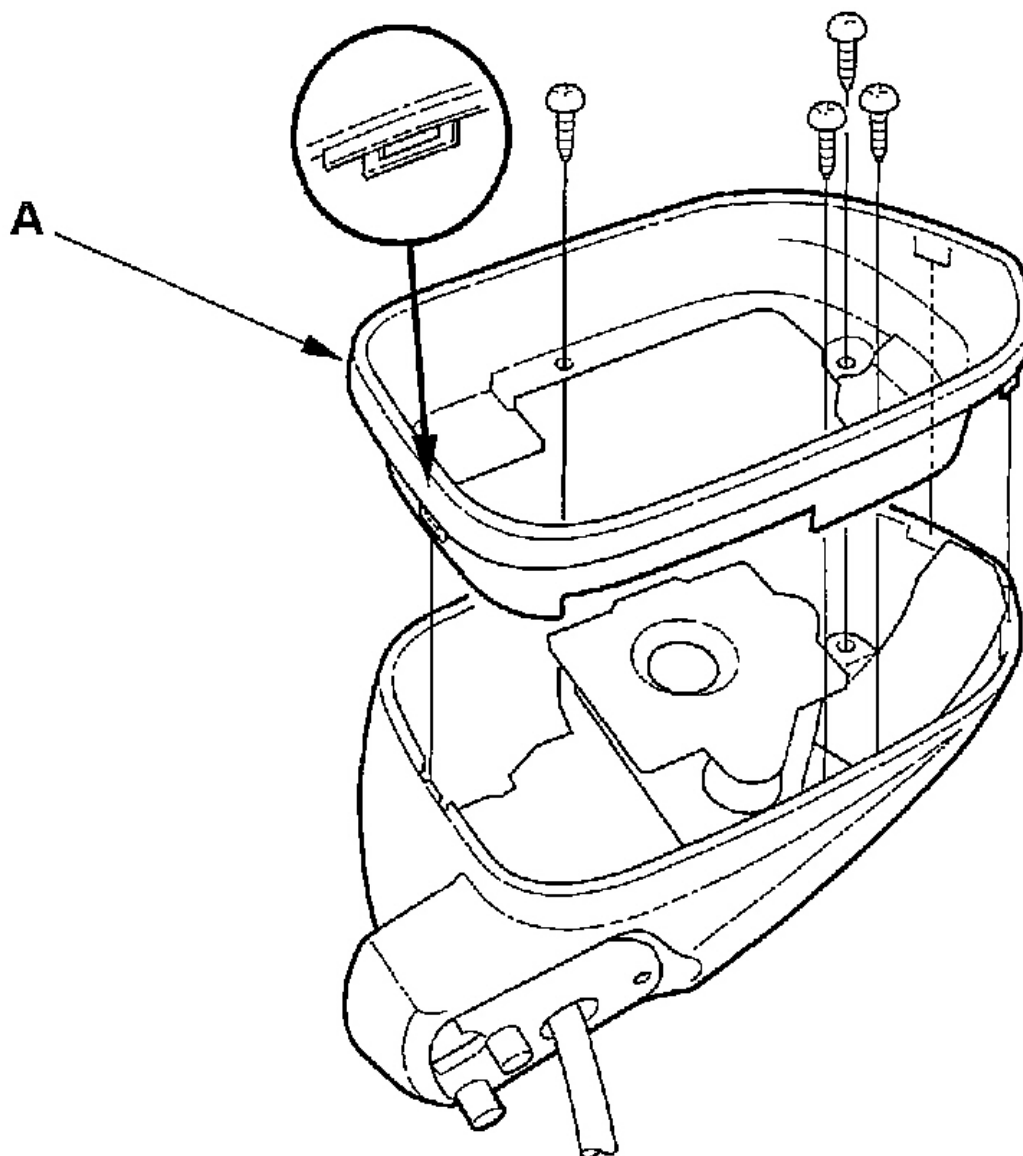
3. Remove the screw from the harness clip (D) and the gasket (E).

4. Remove the three screws, and separate the mirror housing (A) from the bracket (B).



**Fig. 17: Separating The Mirror Housing From The Bracket**

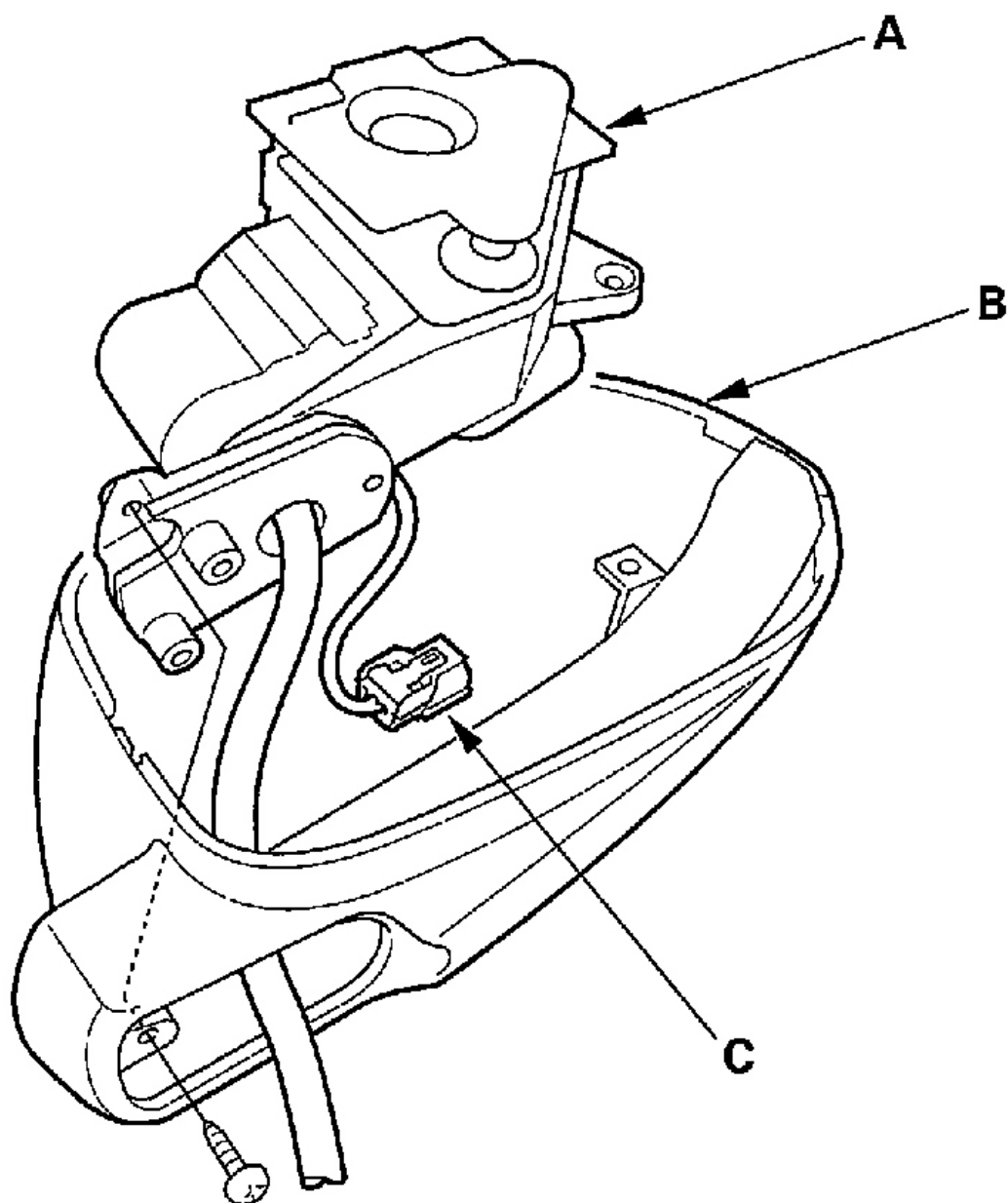
5. Remove the four screws, and the visor (A).



G01821193

**Fig. 18: Removing The Visor**

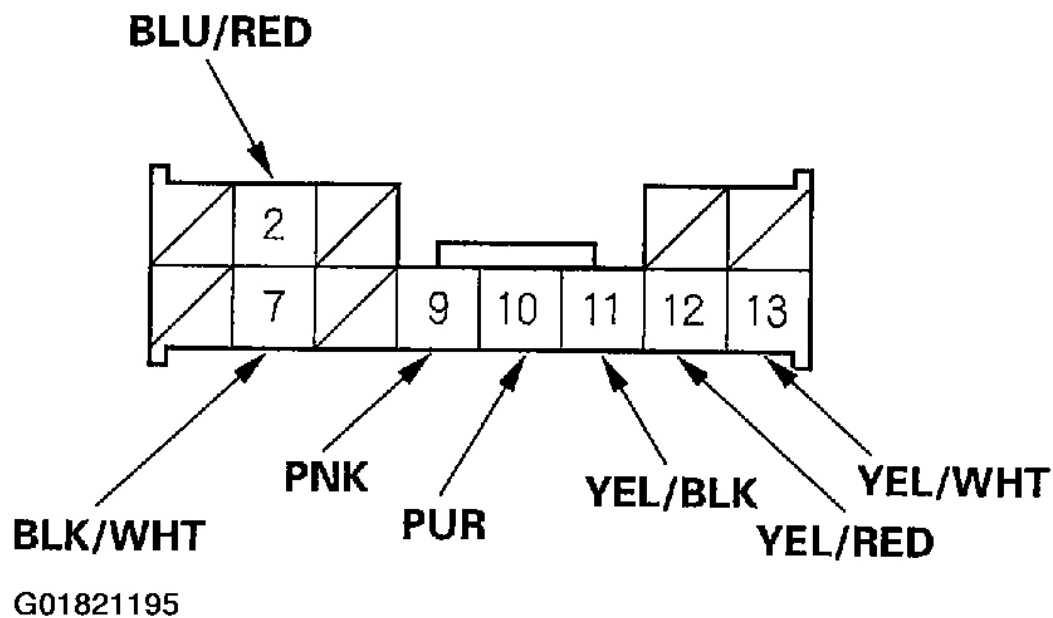
6. Remove the one screw and separate the actuator (A) from the housing (B), then disconnect the 2P connector (C).



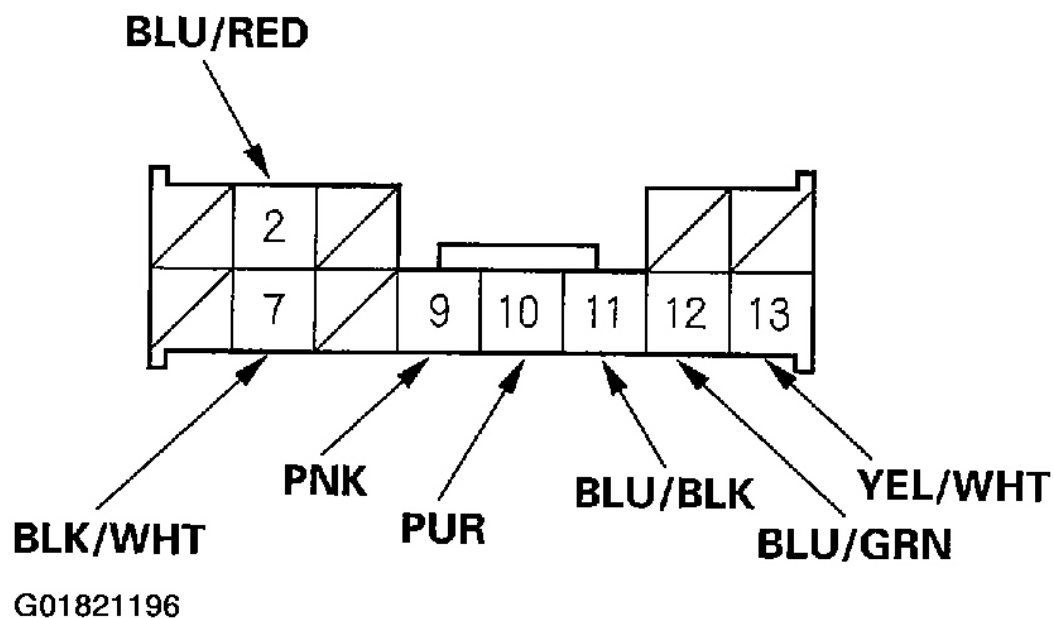
G01821194

**Fig. 19: Separating The Actuator From The Housing**

7. Route the wire harness of the new actuator through the hole in the bracket and gasket.
8. Install the actuator, bracket, harness clip, and gasket in the reverse order of removal.
9. Install the new actuator terminals into the connector in the original arrangement as shown.

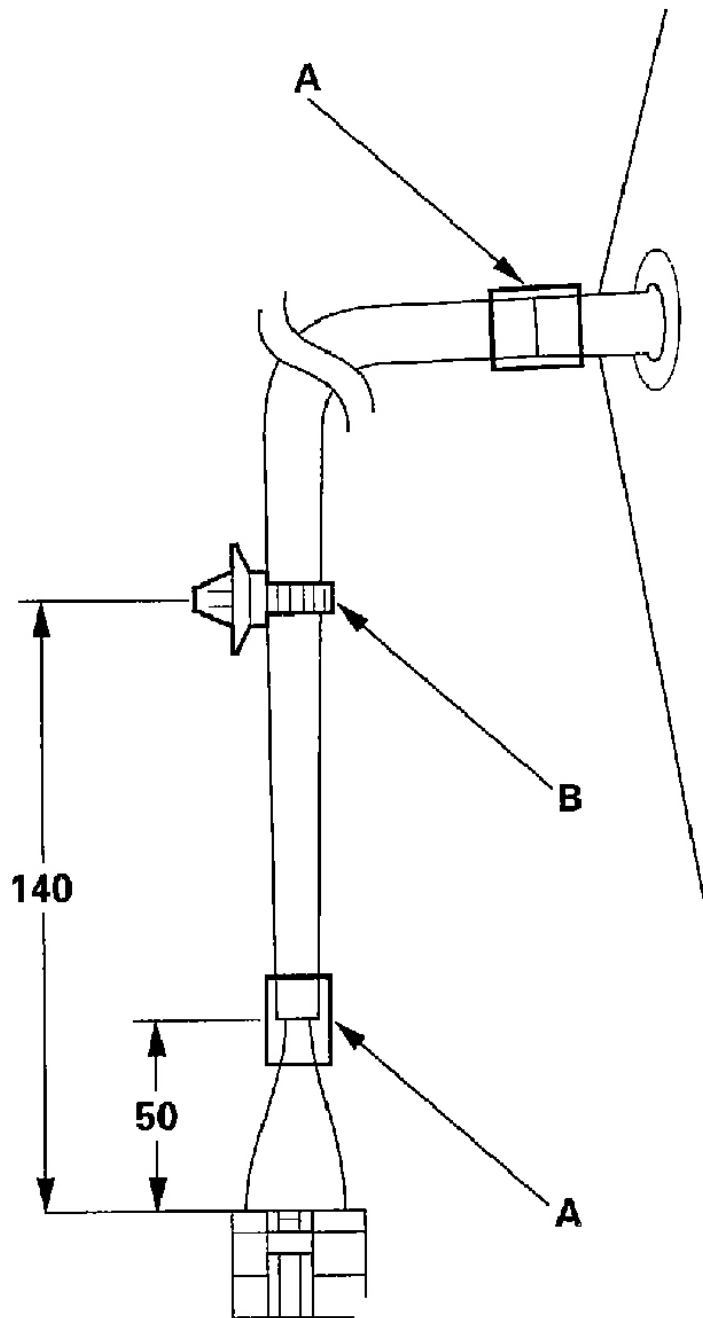


**Fig. 20: Installing The New Actuator Terminals Into The Connector (Left)**



**Fig. 21: Installing The New Actuator Terminals Into The Connector (Right)**

10. Cover the harness hole with a tape (A).



G01821197

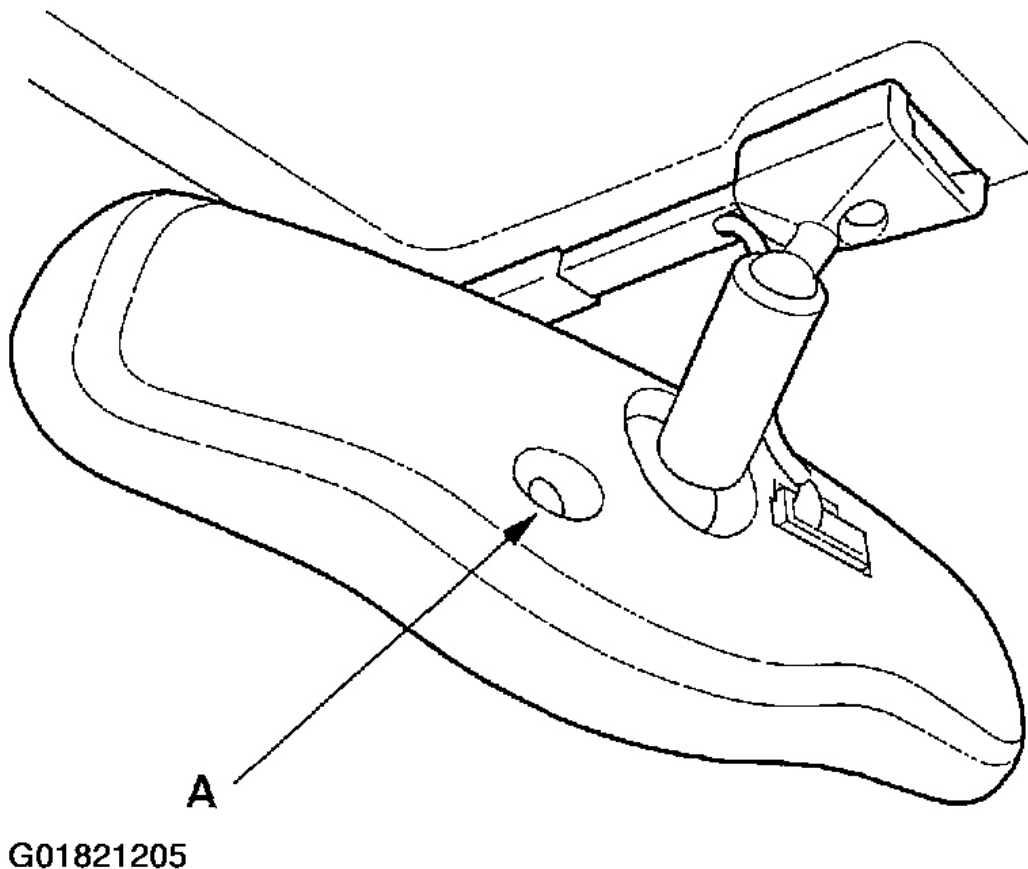
**Fig. 22: Covering The Harness Hole With Tape**

11. Install the clip (B).
12. Reinstall the mirror assembly to the door.
13. Operate the power mirror to ensure smooth operation.

## **AUTOMATIC DIMMING INSIDE MIRROR**

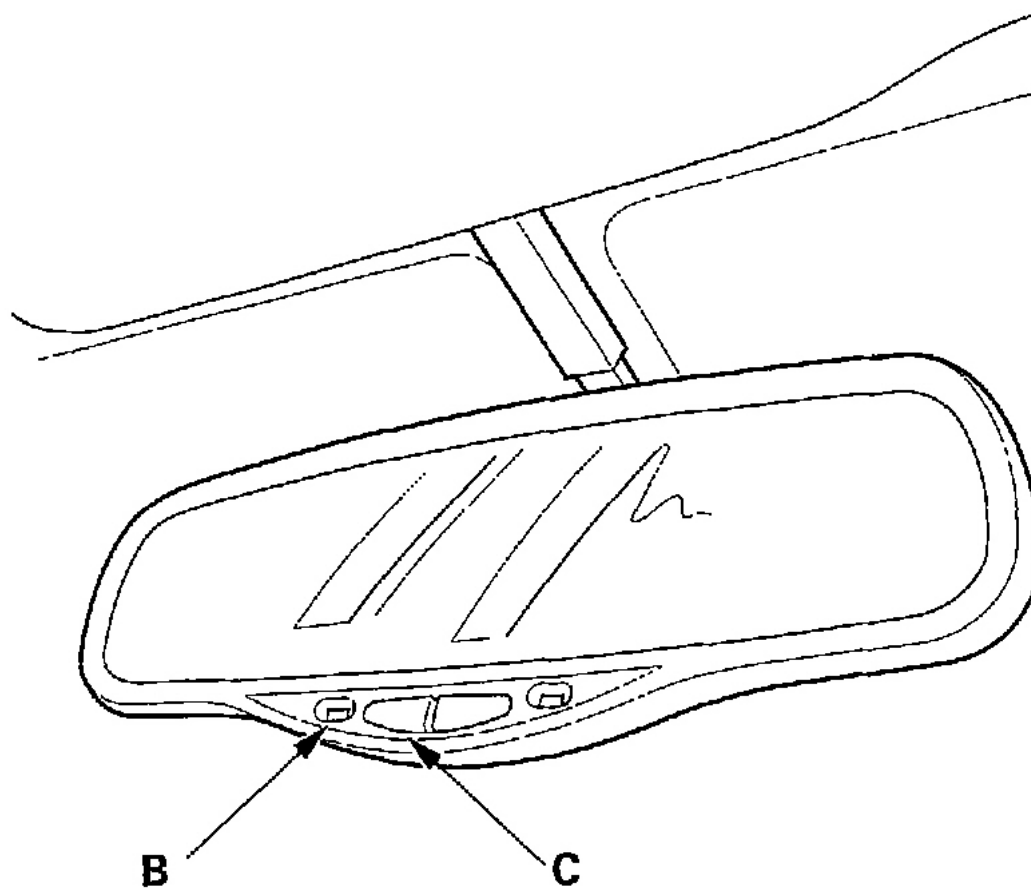
### **DESCRIPTION**

The automatic dimming inside mirror has a front-facing lux level sensor (A), a rear-facing lux level sensor (B), and a control unit. The control unit receives signals from each sensor. Based on the difference between the two lux levels (the light outside the vehicle and the light from the headlights of the other vehicle, etc.), the control unit controls the electro-chromic gel to reduce the glare. This dimming function is canceled when the transmission is in reverse, or when the automatic dimming off switch (C) is turned OFF.



**Fig. 23: Locating Front-Facing Lux Level Sensor**





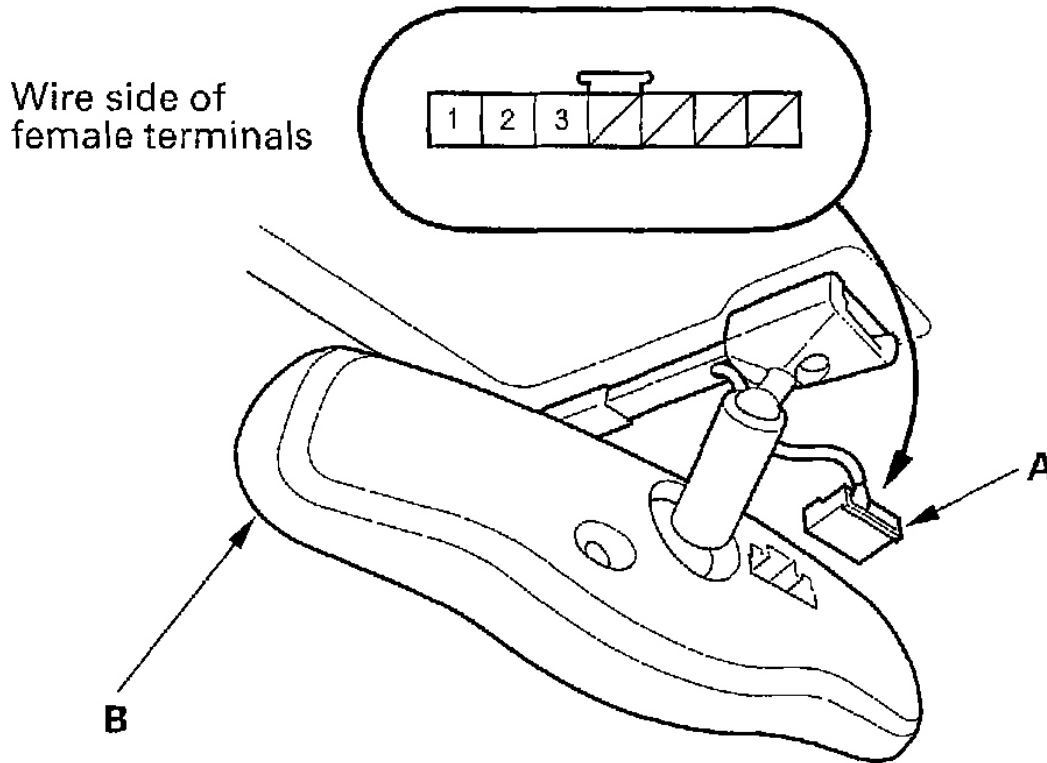
G01821206

**Fig. 24: Locating Rear-Facing Lux Level Sensor & Automatic Dimming Off Switch**

**CIRCUIT DIAGRAM**



2. Disconnect the 7P connector (A) from the automatic inside dimming mirror (B).



G01821208

**Fig. 26: Disconnecting The 7P Connector From The Automatic Inside Dimming Mirror**

3. Check for continuity between No. 2 terminal and body ground.
  - If there is continuity, go to step 4.
  - If there is no continuity, check for:
    - an open in the wire.
    - poor ground (G 503).
4. Check for voltage between No. 1 terminal and body ground with the ignition switch ON (II).
  - If there is battery voltage, go to step 5.
  - If there is no voltage, check for:
    - blown No. 21 (7.5A) fuse in the driver's under-dash fuse/relay box.
    - an open in the wire.
5. Check for voltage between No. 3 terminal and body ground with the ignition switch turned ON (II) and transmission range switch (A/T) or back-up light switch (M/T) in reverse.
  - If there is battery voltage, replace the mirror assembly.

- If there is no voltage, check for:
  - an open in the wire.
  - blown No. 21 (7.5A) fuse in the under-dash fuse/relay box.
  - faulty reverse relay.
  - faulty transmission range switch.